



Republic of the Philippines  
**DEPARTMENT OF PUBLIC WORKS AND HIGHWAYS**  
**OFFICE OF THE SECRETARY**  
Bonifacio Drive, Port Area  
Manila

JUL 16 2013

DEPARTMENT ORDER )  
No. 64 )  
Series of 2013 07-18.13 )

**SUBJECT : GUIDELINES ON THE NEW  
CONSTRUCTION AND  
RENOVATION OF DPWH  
REGIONAL OFFICE BUILDING**

Consistent with the policy of the Department to provide for a uniform design that will identify DPWH Office Buildings, the following guidelines shall be observed in the construction/renovation of Regional Office (RO) Building:

1. For the construction of a new RO Building, the attached standard/conceptual plan (Annex A-1 & Annex A-2) of Two-Storey Standard RO Building, for typical ROs that have standard number of 141 positions (per approved Rationalization Plan) shall be adopted. Although the location of offices may be interchanged, the office space area requirements and exterior design features and color scheme (Annex B) as shown in the floor plans and perspective shall be strictly adhered to.
2. The minimum front setback from the property line of the proposed RO building should be adequate (about 15.00 m) to provide space for driveway and assembly place of personnel during flag-raising ceremonies.
3. In case the conceptual plan cannot be accommodated in a proposed site for the new RO Building, the concerned RO shall submit to the Bureau of Design (BOD) the lot plan indicating its technical descriptions, contour lines and existing structures/utility lines, if any, for design modifications.
4. For the renovation of existing RO buildings and other existing DPWH buildings which are proposed to be converted to RO, the exterior design features and color scheme shall conform to the standard plan.

This Order shall take effect immediately.

  
**ROGELIO L. SINGSON**  
Secretary

Department of Public Works and Highways  
Office of the Secretary



WIN3R00789

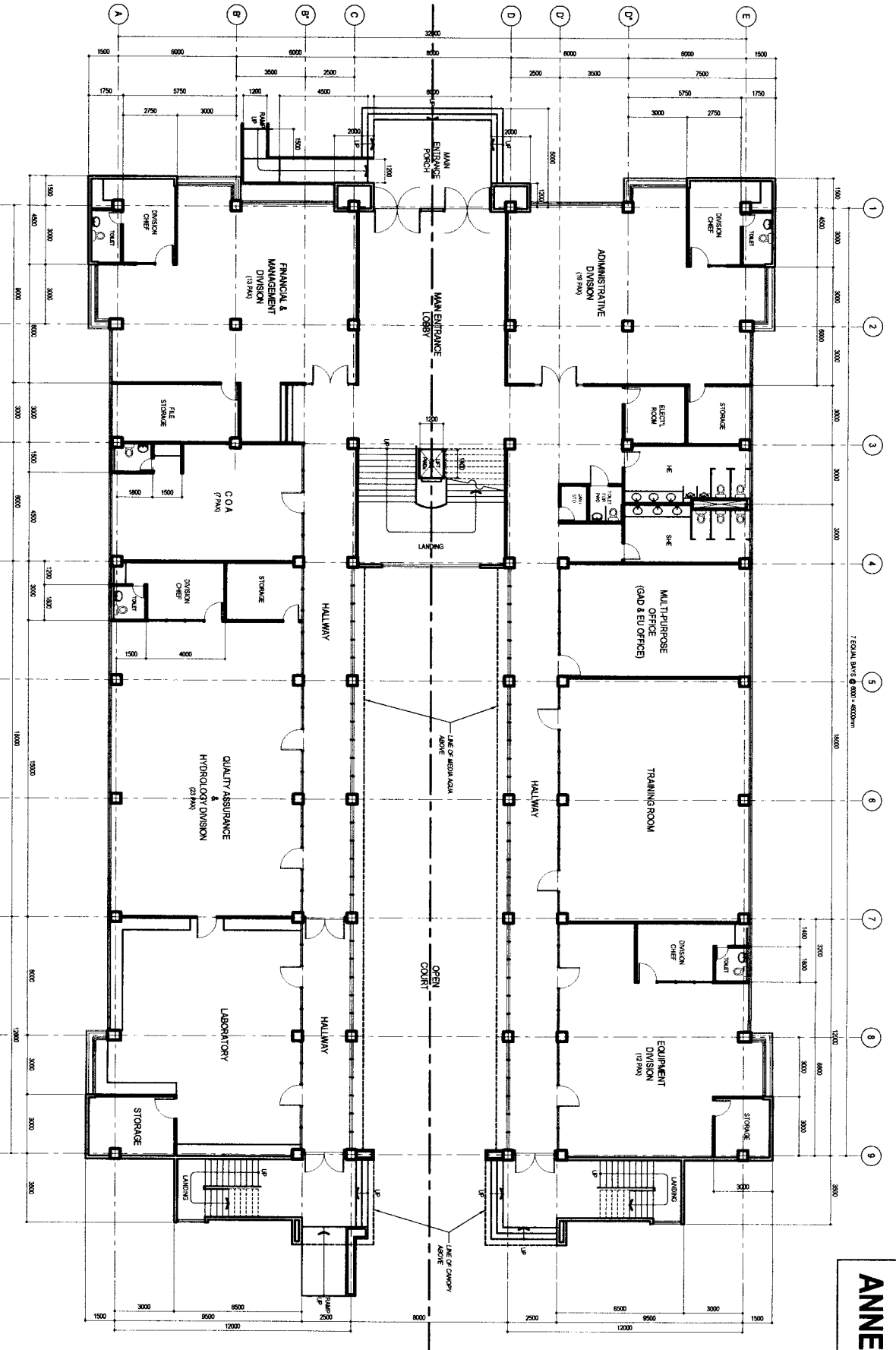

# GROUND FLOOR PLAN

CONCEPTUAL PLAN OF:  
STANDARD TWO-STORY  
DPWH REGIONAL  
OFFICE BUILDING  
AREA PER FLOOR = 1,464± SQ. M.  
TOTAL FLOOR AREA = 2,928± SQ. M.

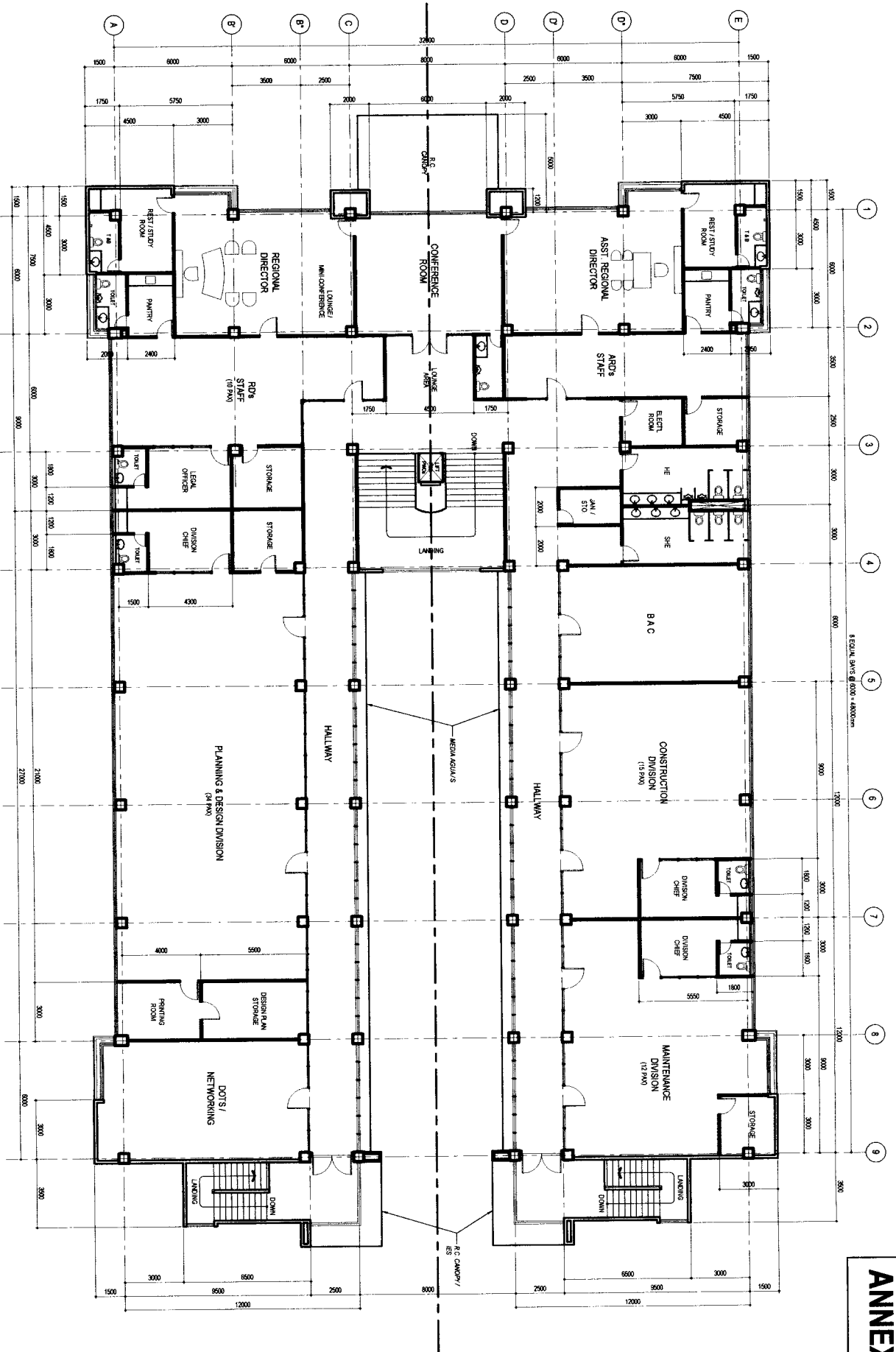

SECOND FLOOR PLAN

CONCEPTUAL PLAN OF:  
STANDARD TWO-STORY  
**DPWH REGIONAL  
OFFICE BUILDING**  
AREA PER FLOOR = 1,464 SQ. M.  
TOTAL FLOOR AREA = 2,928 SQ. M.





**PROPOSED  
TWO (2) - STOREY STANDARD  
DPWH REGIONAL OFFICE BUILDING**